

TGM50 TOUCH SCREEN THERMOSTAT

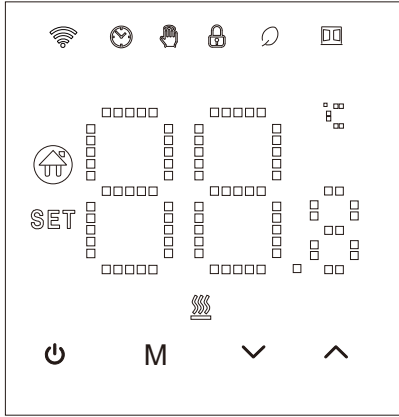

This thermostat is used for water heating, electric heating, or gas boiler.

Welcome

Thank you for your trust and support! We have adopted advanced technology and perfect craftsmanship so that your new thermostat will provide you with a suitable temperature environment every day in the future. It makes your life more pleasant and artistic and making your living environment more fashionable aesthetic. For detailed instructions on installing and using this thermostat, please read this manual carefully. Please get in touch with a professional to install the thermostat for you. Besides, please install and use this product within the scope of the law.

Application

The intelligent digital humidity controller is a floor heating system suitable for room temperature control and household temperature control. It controls the operating status of the floor heating equipment by sensing the comparison between the ambient temperature and the set temperature. While improving comfort, it achieves the purpose of energy saving. The digital thermostat adopts microcomputer control technology and has an elegant design, and is easy to use. Moreover, it has manual and automatic functions, programmable functions, and state memory functions.

Product Package

Thermostat host	1 pc
Guide/manual	1 pc
Certificate of conformity	1 pc
Screw	2 pcs
External sensor (optional)	1 pc

Electrical Specifications

1. Temperature Sensor : NTC
2. Temperature accuracy : $\pm 1^{\circ}\text{C}$
3. Display screen: LCD
4. Working environment: $-5\sim 50^{\circ}\text{C}$
5. Self-consumption power: $< 1\text{W}$
6. Temperature setting : $5\sim 60^{\circ}\text{C}$
7. Display range: $0\sim 51^{\circ}\text{C}$
8. Load current: water heater 3A
electric heater 16A
gas boiler 3A
9. Voltage : AC100- 240V, 50/ 60Hz

User Instructions

1. Read this manual carefully. A general operation may damage the product or cause a dangerous situation.
2. The installation personnel must be well -trained and experienced service technicians.
3. After the installation is complete, please close this manual carefully and operate this product following the user guide.

Note: There is a risk of electric shock or equipment damage.

Wiring Diagram

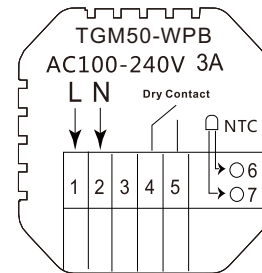
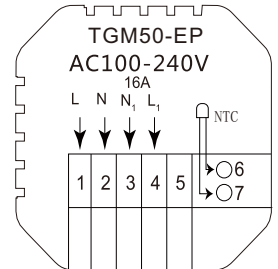
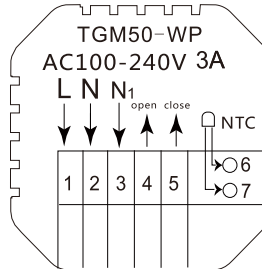

Note: WP for water heating; EP for electric heating; WPB for gas boiler

Mounting Steps

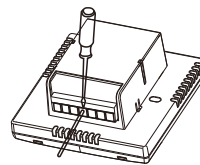

1. Connect the power box according to the wiring diagram

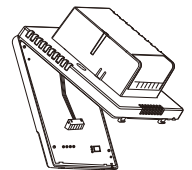

2. Separate the power supply from the control board cable

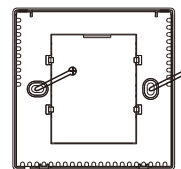

3. Screw the power supply into the box of 86

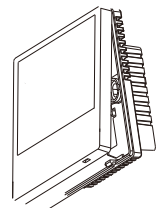

4. Connect the power board to the control board line, and align the buckle at 30 degrees to complete the installation.

Icon Description

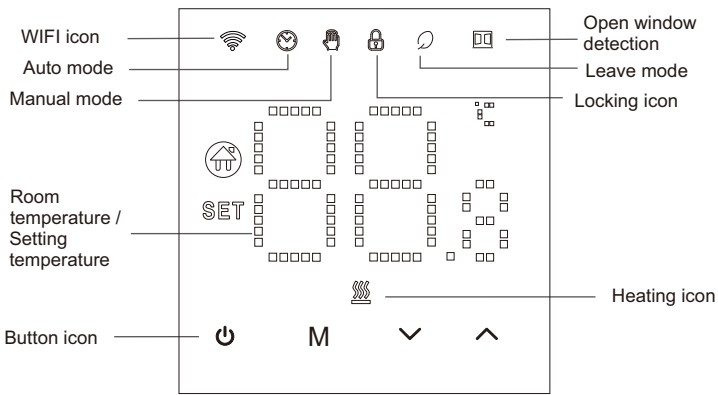

Operation Guide

1. Power on/off: press the key to turn on/of the thermostat.
2. Press the **M** key to switch between Manual and Leave modes.
3. Simultaneously press and hold the and keys for 5 seconds to add or cancel the child lock.
4. WIFI link: When the thermostat is turned on, press and hold the button for five seconds, the Wi-Fi icon flashes on the thermostat display, and the thermostat enters the Wi-Fi configuration state.

Time Programming Instructions

Options		Icon	Time	Time Adjustment	Defaults	Temperature adjustment
Working days	1		06:00		20°C	
	2		08:00		16°C	
	3		11:30		16°C	
	4		12:30	16°C		
	5		17:00	22°C		
	6		22:00	16°C		
Holidays	1		08:00	22°C		
	2		23:00	16°C		

Advanced Option Setting

In the **POWER OFF** state, long press the **M** key and key for 5 seconds to enter the advanced option setting.

Press the **M** key to enter the next option, then press the key or key to adjust options. Press key to exit the advanced option setting mode.

01	Temperature compensation	The default value of the calibration room temperature is -1°C. Press the up or down key to adjust the range from 9.9°C to -9.9°C.
02	Sensor selection	The temperature sensor selection defaults to IN. Press the up key or down key to adjust it respectively as IN internal sensor selection. ALL means all internal sensors are selected; OUT means external sensors are set.
03	Limit temperature value modification	The limit temperature value is 60°C by default. Press the up or down key to adjust the range from 25°C to 95°C.
04	Temperature accuracy	The default setting temperature accuracy is 1°C; press the up or down key to adjust the range from 0.5°C to 10°C.
05	Antifreeze function	The default setting for antifreeze function is OFF; press the up key to turn on the function. ATT: if Antifreeze function is turned on, when you turn off the thermostat, the room temperature and power key is still displayed.
06	Rest day selection (optional) and closing weekly program	5: Two-day weekend 6: Single day off 7: No rest OFF: Turn off programming
07	Main and auxiliary reverse selection (optional)	Set the main and auxiliary reverse to 00 by default. Press the up or down key to adjust 00 main reverse, and 01 indicates the auxiliary reverse. ATT: it is not recommended to adjust without professional guidance.
08	Standby backlight brightness	00: Turn off the backlight 01: Brightness always on (Low) 02: Brightness always on (Mid) 03: Brightness always on (High) The default setting is 02
09	Set temperature limit	Set the upper limit of the temperature to 60°C; press the up or down key to adjust the range from 15°C to 95°C.
10	Sound	ON: Turn on the sound OFF: Turn off the sound
11	Window opening detection	ON: Turn on the window opening detection OFF: Turn off the window opening detection The default setting is ON. ATT: When the window opening detection is turned on, if the room temperature drops by 6°C within 4 minutes, then window opening mode will be triggered. At this time, the thermostat will stop heating, and the window opening detection icon is displayed. After the window opening mode is triggered, in the following three conditions, the mode will be exited: 1. the room temperature rises by 3°C 2. 48 minutes after triggering 3. manual
12	Power outage memory function	0: memory function 1: Turn on after turning on the power 2: Turn off after turning on the power
13	Reset	Set to restore factory settings The default display is "-_" press the up key to display "-_ _", and then press the enter key to restore the factory settings.

About Wi-Fi Connection

Before using the WIFI temperature controller for the first time, you must set the WIFI value number and configuration via your smart phone or tablet, which will allow communication between your connected devices.

WIFI connection: When the thermostat is turned on, press and hold the up button for 5 seconds, the WIFI icon flashes on the thermostat display, and the thermostat enters the code matching state.

WIFI connection: Bluetooth thermostat, please turn on the phone's Bluetooth

1. APP download

Search for "Tuya Smart" in each APP market or scan the following QR code to download this software:



2. Register an account

If you do not have an APP account, you can choose to register or log in via SMS verification code. Click "Create New Account" to enter the privacy policy page of Tuya Smart Platform. After clicking Agree, you will formally join the registration page of your mobile phone number.

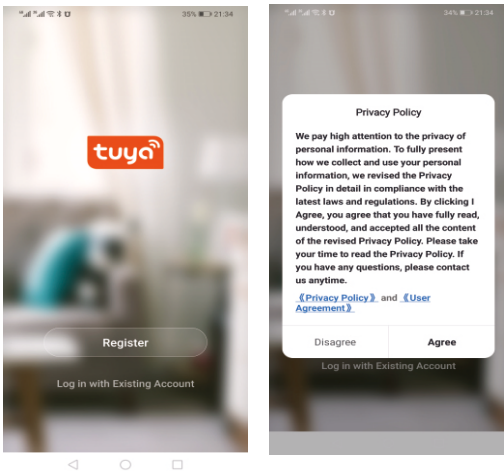

The system automatically determines the current country/region, or you can manually select the country/region, enter your phone number or email address, and click "Get the Verification Code". Enter the received verification code. Then enter the password. Click "Finish" to register successfully.

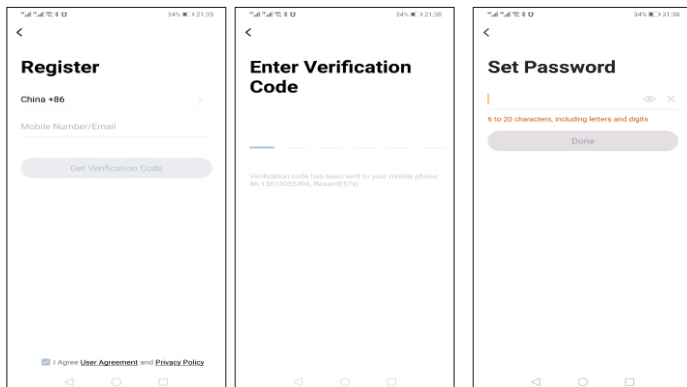

3. Add gateway device

Click "Add Device" or "+" on the top right of the APP homepage, and enter the "Add Device" interface.

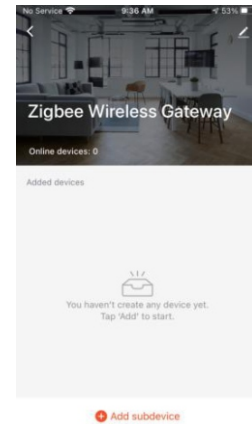
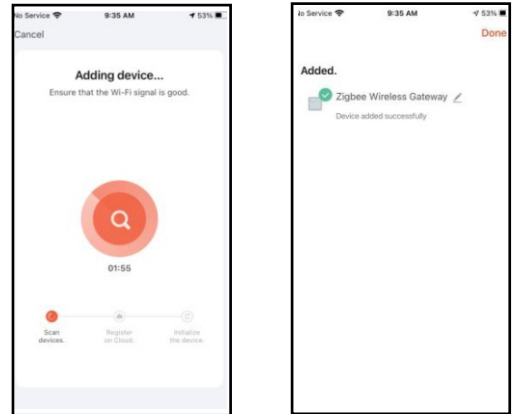
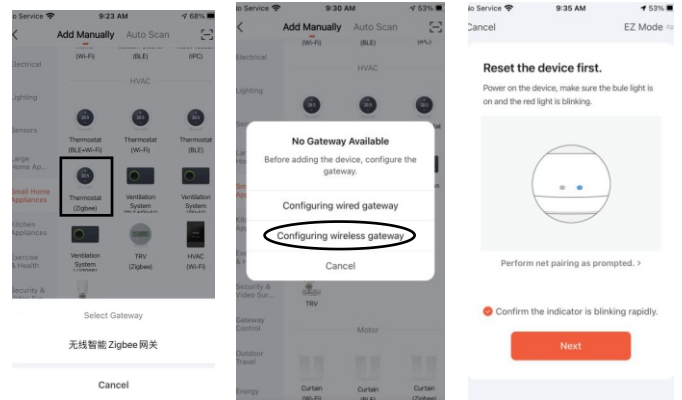

4. Thermostat add

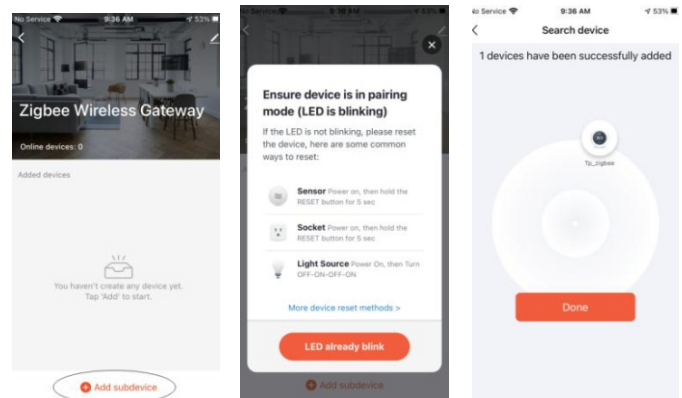

5. Display of temperature controller APP interface

